

# AUGUSTUS WALL PACK LIGHT (FULL CUTOFF)

## IMPORTANT SAFEGUARDS

### GENERAL SAFETY INFORMATION

- To reduce the risk of death, personal injury or property damage from fire, electric shock, falling parts, cuts/abrasions, and other hazards read all warnings and instructions included with and on the fixture box and all fixture labels.
- Before installing, servicing, or performing routine maintenance upon this equipment, follow these general precautions.
- Commercial installation, service and maintenance of luminaires should be performed by a qualified licensed electrician.
- For Residential installation: If you are unsure about the installation or maintenance of the luminaires, consult a qualified licensed electrician and check your local electrical code.
- **DO NOT INSTALL DAMAGED PRODUCT!**
- This fixture is intended to be connected to a properly installed and grounded UL listed junction box.

### WARNING:

#### RISK OF ELECTRICAL SHOCK

- Turn off electrical power at fuse or circuit breaker box before wiring fixture to the power supply.
- Turn off the power when you perform any maintenance.
- Verify that supply voltage is correct by comparing it with the luminaire label information.
- Make all electrical and grounded connections in accordance with the National Electrical Code and any applicable local code requirements.
- All wiring connections should be capped with UL approved wire connectors.

### CAUTION:

#### RISK OF INJURY

- Wear gloves and safety glasses at all times when removing luminaire from carton, installing, servicing or performing maintenance.
- Avoid direct eye exposure to the light source while it is on.
- Account for small parts and destroy packing material, as these may be hazardous to children.

### CAUTION:

#### RISK OF FIRE

- Keep combustible and other materials that can burn away from luminaire and lamp/lens.
- MIN 90°C SUPPLY CONDUCTORS.

*Illustrations on the manual are for installation purposes only. It may not be identical to the fixture purchased.*

## GENERAL WIRING DIAGRAM

CAUTION: Turn off electrical power at fuse or circuit breaker box before wiring fixture to the power supply.

All units must be individually connected to the AC supply. (see page 1 for voltage by model)

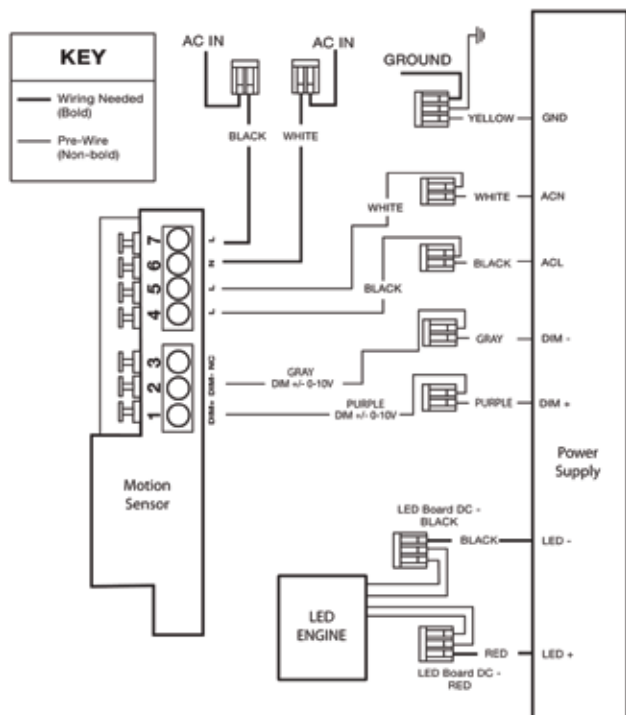

## AC WIRING INSTRUCTIONS

1. Feed wires through wire way and secure using connector (not supplied).
2. Connect supply wires to quick connect originating from INPUT side of driver. Black/Hot supply to quick connect with black wire. White/Neutral supply to quick connect with white wire. Be sure to confirm connections are secure.
3. Connect ground wire to quick connect with green wire. Be sure to confirm grounding connection is secure.

AUGUSTUS WALL PACK LIGHT (FULL CUTOFF)



INSTALLATION & OPERATION

DISCONNECT THE POWER BY TURNING OFF THE CIRCUIT BREAKER OR BY REMOVING THE APPROPRIATE FUSE AT THE FUSE BOX. TURNING THE POWER OFF USING THE LIGHT SWITCH IS NOT SUFFICIENT TO PREVENT ELECTRICAL SHOCK.

- 1. Drill three mounting holes into mounting surface using a 3/8" drill bit. Use template to locate mounting holes.
- 2. Use a screwdriver to loosen (2) screws securing fixture door. Remove fixture rear housing from fixture.
- 3. Use a flat head screw driver to remove appropriate wire way covering from back plate of housing.
- 4. Take care to avoid damaging driver, wires and quick connectors and drill holes through castings over fixture mounting holes.
- 5. Affix fixture to mounting surface by installing anchors (not supplied) through fixture mounting holes into holes drilled into the mounting surface. Be sure to use an anchor appropriate for the mounting surface in which the fixture is installed.

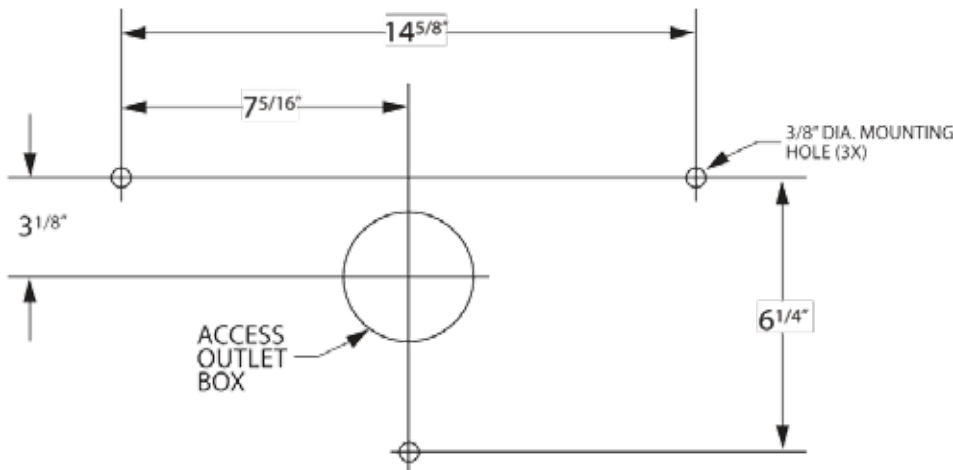

- 6. Add 1/4" bead of exterior grade silicone sealant around the perimeter of the wall pack on the wall to inhibit any moisture from attachment screws.
- 7. Reattach fixture front to fixture rear housing.
- 8. Cut all plastic zip ties.
- 9. Follow general wiring diagram on page 2.
- 10. Set motion sensor settings following instructions on page 4. (Default settings shown below.)

DEFAULT SETTINGS

Detection Area				Hold-time				Daylight Sensor				Stand-by Period				Stand-by Dimming Level			
	1	2			1	2	3		1	2			1	2	3			1	2
I	●	●	100%	V		●	●	10min	III		●	10Lux	VIII				+ ∞	III	●

- 11. Reattach fixture using two screws removed in installation step 2.